

Subject: Application for Annexation and Zoning to RS6, CUP

The current zoning is Rural Residential (RS), as designated by Canyon County. The proposed development aligns with the Medium Density Residential designation in the Nampa Comprehensive Plan Future Land Use Map. All proposed uses within this development are compatible with the adjacent zoning districts.

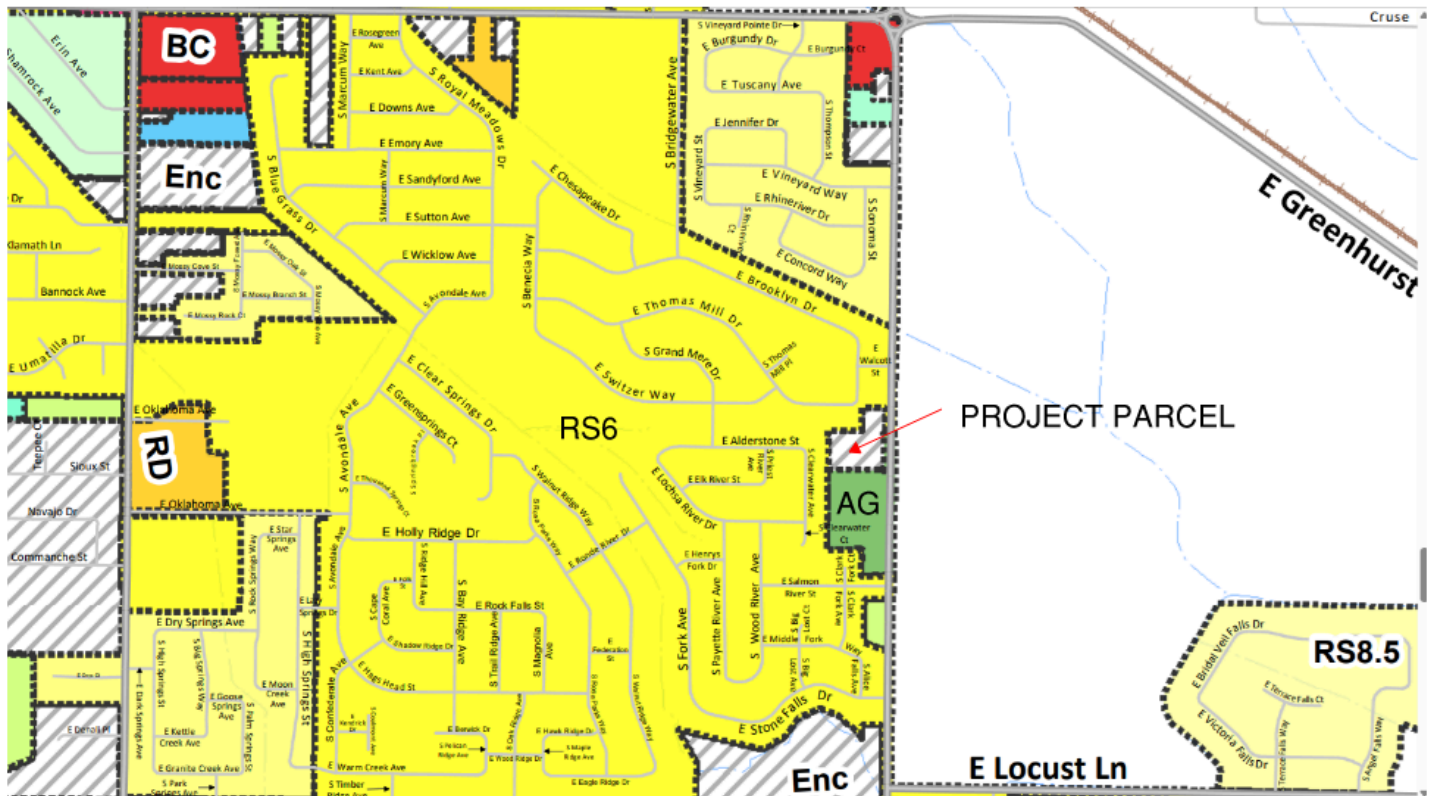

This project will redevelop the existing structure and site to accommodate the proposed Live in outpatient treatment on 0.747 acres of RS6-zoned property. The site will be redeveloped to meet the zoning requirements of the City of Nampa for Single-Family Residential (RS6) uses.

The layout for Rock Bottom recovery and Treatment Services includes interior renovations to the existing structure, along with the addition of exterior ADA-compliant ramps. The site will also be improved to provide parking for both visitors and staff.

Conditional Use Permit

This project is requesting approval of a Conditional Use Permit (CUP) for the proposed Rock Bottom recovery and Treatment Services, located on the northwest portion of the project parcel, in accordance with Section 10-3-2 of the City of Nampa Zoning Ordinance. The facility will include up to 11 rooms and 13 beds.

Summary

Rock Bottom recovery and Treatment Services will be a valuable addition to the surrounding community, providing a supportive living environment for individuals in their later years and allowing families to remain close by.